

# perfect fit venetian blinds fitting instructions

- 1) Carefully unwrap the parcel, taking great care not to cut any of the cords, if using scissors or a knife. Lay out the frame on it's front face, with the closed blind at the top.
- 2) Slide each corner Joint into the vertical and horizontal frame pieces to create a rectangular frame. Do this by pushing the protrusions into the groove in the aluminium lengths until they are fully inserted. Then tighten the small screws to secure all four corners in place. Make sure you do not trap any loose cords whilst doing this.
- 3) If not already fitted, install the corner covers by pushing over the corner of the frame and securing at the back using the screws provided.
- 4) Use a credit card or the measuring card provided. Place the card in the top left hand corner of the visible glass area to find the correct position to install the 1st bracket. At the bottom edge of the card, slide one of the brackets under the glazing gasket until it is tight up against the bead. **TIP: Light lubrication with washing-up liquid may make this easier in some cases.** Repeat in all four corners of the window pane. This will ensure alignment with the holes in the frame members. (Note: in extra tall or extra wide windows, additional brackets may be necessary in intermediate positions, and will be automatically supplied).
- 5) Line up the holes in the Perfect Fit Frame, with the window fixing brackets and simply clip the frame onto one bracket at a time so that the small clip pops into the adjacent hole, retaining the Perfect Fit frame in place on the window frame.

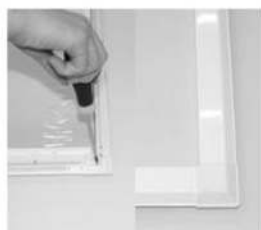

## Removal & Replacement

- 1) To remove your blind for cleaning or replacement, raise the blind to the open position.
- 2) Simply prise the clip out of each hole one at a time, using a flat-blade screwdriver and remove the Perfect Fit Frame, leaving the clips in place.